



## WATER SYSTEMS & VENTILATION

CATEGORY OVERVIEW .....	4
BILGE PUMPS .....	5-7
AERATOR PUMPS .....	8-9
BILGE & FLOAT SWITCHES .....	10
SHOWER & WASHDOWN SYSTEMS .....	11-12
HAND OPERATED PUMPS .....	13
PUMP KITS & ACCESSORIES .....	14-15
PLUMBING SYSTEM FITTINGS.....	16
STAINLESS STEEL THRU-HULLS & SCUPPER VALVES FITTINGS.....	17-19
STAINLESS STEEL CAPPED COMPOSITE THRU-HULLS .....	20
PLASTIC THRU-HULLS & SCUPPER VALVE FITTINGS .....	21-22
DRAINS, DRAIN PLUGS & TUBES .....	23-24
MAXIMUM EFFICIENCY BLOWERS.....	25
VENTS & COLLECTOR BOXES.....	26-28



## WATER SYSTEMS & VENTILATION

# COMPLETE SELECTION

A complete selection of pumps and blowers are available for fishing boats, runabouts, cruisers, yachts, and commercial boats. Attwood bilge pumps and blowers are tested and approved as standard equipment by leading boat manufacturers.

## Bilge and Aerator Pumps

The Heavy-Duty 1700 and 2000 bilge pumps have established Attwood into the commercial market with value-loaded industrial-duty features and performance.

The Tsunami series of cartridge style bilge and aerator pumps are engineered for higher performance in the most service friendly design imaginable. Their cartridge style allows quick and easy replacement without the need to remove hoses or mounting bases.

## Automatic Bilge Pumps

All boats over 20' long with sleeping accommodations (excluding fold-out cockpit seats) should use automatic bilge pump systems. Non-automatic pumps drawing 12-amps or less can easily convert to automatic operation with an Attwood Automatic Float Switch (part number 4201 or 4202).

Our Sahara Series automatic pumps are available in 500, 750 and 1100 gph capacity models.

Bilge pumps are designed to exhaust standing water only. They are not intended to prevent rapid accumulation of on-board water due to rough weather, hull damage, and/or other unsafe navigational conditions. Note: Bilge and aerator pumps must be lower than the source of water for priming.

## Turbo In-Line Blowers

Attwood offers ventilation equipment and accessories featuring the revolutionary, patented Turbo In-Line Blowers for 3"- and 4"-diameter systems. Turbo blowers are the most dependable, efficient, and powerful in-line blowers on the market, designed using aerospace technology. The Turbo line also features the industry's first water-resistant blower models, with durability proven in rigorous moisture tests and years of success in the field. Attwood offers Turbo water-resistant blowers with an unprecedented three-year limited warranty, and a one-year limited warranty for standard models.

## Certification, Standards, and Listings - Pumps

All Attwood pumps meet or exceed the following U.S. and international certificates and standards:

- ABYC H-22
- ISO 8846, 8849 Marine
- U.S. Coast Guard Rule, Title 33CFR sections 183.410 and 33CFR 183.425
- NMMA "As Approved Listing"
- IMCI (CE)

## Certifications, Standards and Listings - Blowers

Attwood in-line blowers meet or exceed the following U.S. and international certificates and standards:

- ABYC-H2; ISO 9097
- U.S. Coast Guard Rules, Title 33 CFR sections 183.410, and 183.610 (b)
- Tested to ANSI/AMCA (210-85) and ANSI/ASHRAE (51-1985) standards
- NMMA "As Approved Listing"
- IMCI (CE)

## Choice of Electrical Connectors

Attwood pumps feature several wire attachment styles to adapt to your boat's wiring harness. Standard wire on all pumps are tinned and caulked 16-gauge for butt connection

Special connectors are available on special order by contacting your Attwood representative. Minimum order quantity is 250:

- Packard Connector
- Packard Connector, Water-Resistant
- Amp Connector
- Amp Connector, Water-Resistant
- Deutsch Connector
- Quick Silver Connector

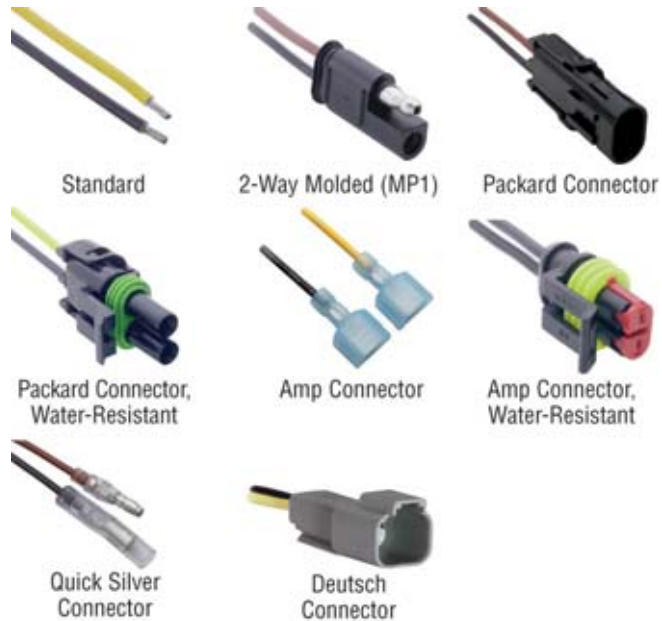

# SAHARA AUTOMATIC BILGE PUMPS

An automatic-switch bilge pump is a requirement for any vessels 20' and over with sleeping accommodations, but is a great convenience for any size boat. The Sahara has everything contained in one compact yet durable package – pump, wire seals, strainer, and **mercury-free** switch – and installs quickly and easily in tight spaces. Pumps include 36" lengths of 16-gauge caulked and tinned copper wire.

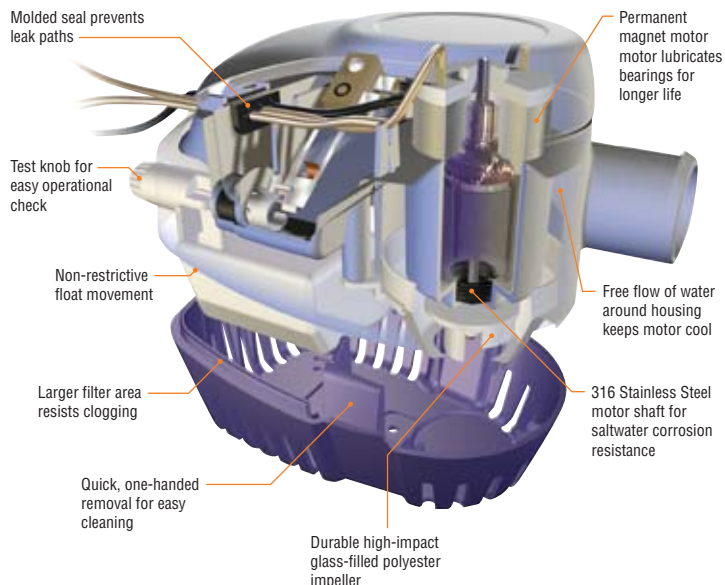

## NMMA Numbers

Part No.	NMMA No.	IMC (CE) Certificate No.
4505 Series	090085	PATT039
4507 Series	090090	PATT038
4508 Series	2456897	PATT041
4511 Series	090095	PATT040

## Specifications

				GPH Output @ Design Voltage 13.6 VDC				GPH Output @ Nominal Voltage 12.0 VDC						
Model No.	Rated Voltage	Design Voltage	Amp Draw	0 ft.	3.3 ft.	6.7 ft.	Max Head	Amp Draw	0 ft.	3.3 ft.	6.7 ft.	Max Head	Fuse Size	Hose Size
S500	12	13.6	1.5	375	480	220	9 ft.	1.2	570	390	190	8 ft.	3-amp	3/4" I.D.
S750	12	13.6	2.8	750	625	450	16 ft.	2.5	660	480	345	12 ft.	5-amp	3/4" I.D.
S750	24	27.2	1.5	750	625	450	16 ft.	1.2	660	480	345	12 ft.	2-amp	3/4" I.D.
S1100	12	13.6	4	1100	973	750	11 ft.	3.4	1070	820	615	9 ft.	6-amp	1-1/8" I.D.
S1100	24	27.2	1.9	1100	973	750	11 ft.	1.4	1070	820	615	9 ft.	3-amp	1-1/8" I.D.

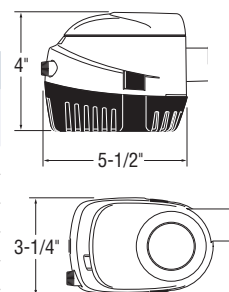

## S500 Pump

S500 has plenty of pumping power for most jobs. 500 GPH\* at open flow, 350 GPH\* at 3.3' head. Draws only 1.5-amps at open flow!

Model No.	Rated Voltage	Hose Size	Wire/Connector	Bulk Packaging	Aftermarket Packaging**
S500	12-volt	3/4" I.D.	29" wire	4505-1	4505-7
S500 with Stainless Steel Strainer	12-volt	3/4" I.D.	29" wire	4505S1	—



## S750 Pump

S750 is sized for larger recreational boats. Our most powerful 3/4"-outlet automatic pump. 750 GPH\* at open flow, 625 GPH\* at 3.3' head. 3/4" hose outlet.

Model No.	Rated Voltage	Hose Size	Wire/Connector	Bulk Packaging	Aftermarket Packaging**
S750	12-volt	3/4" I.D.	29" wire	4507-1	4507-7
S750 with Stainless Steel strainer	12-volt	3/4" I.D.	29" wire	4507S1	—
S750	24-Volts	3/4" I.D.	29" wire	4508-1	—



## S1100 Pump

S1100 is our most powerful and efficient automatic pump. High capacity for larger boats and yachts. 1100 GPH\* at open flow, 973 GPH\* at 3.3' head. 1-1/8" hose outlet.

Model No.	Rated Voltage	Hose Size	Wire/Connector	Bulk Packaging	Aftermarket Packaging**
S1100	12-volt	1-1/8" I.D.	29" wire	4511-1	4511-7
S1100 with Stainless Steel strainer	12-volt	1-1/8" I.D.	29" wire	4511S1	—
S1100	24-Volts	1-1/8" I.D.	29" wire	4512-1	—



\* Listed GPH is measured at design voltage of 13.6 VDC.

\*\*Clamshell

BILGE PUMPS

WATER SYSTEMS & VENTILATION

5



# HEAVY-DUTY BILGE PUMPS

**3**  
YEAR  
WARRANTY

Integrates the highest quality bearings, brushes, alloys and magnets designed to withstand extreme usage cycles. Pump also employs an exclusive shaft and motor compartment, reducing wear and significantly extending pump life. Advanced resin compositions incorporated into exterior to resist chemicals such as engine oil, aggressive detergents and hose plasticizers. Attwood's Heavy Duty Bilge has unsurpassed durability and efficiency in a compact design to ensure electrical energy is converted to the pump rather than excess heat.

Tinned and caulked wire improves corrosion-resistance and eliminates water damage

Molded two-wire seal eliminates a potential leak path

Enhanced SS alloy motor shaft resists corrosion and reduces shaft seal degradation

Mechanically energized shaft seal improves pump durability and extends motor life

**new**

High-efficiency permanent magnet motor utilizes composite brushes and lubricated bearings to ensure long life under the most aggressive load conditions

Rugged glass- and mineral-filled polymer components withstand hull pounding, harsh bilge environments and deteriorating effects of hose plasticizers

**Anti-Airlock nozzle exhausts air that causes air lock while preventing spray streams**

Rotating outlet provides for improved hose installation

Interior and exterior attachment holes offer multiple mounting options

Locking tab and base swivel feature allow for 8 unique mounting positions

## NMMA Numbers

Part No.	NMMA No.	IMCI (CE) Certificate No.
4730 Series	2528243	PATT047
4760 Series	2528245	PATT048
4770 Series	2528246	PATT048

## Specifications

GPH Output @ Design Voltage 13.6 VDC							GPH Output @ Nominal Voltage 12.0 VDC						
Model No.	Rated Voltage	Amp Draw	0 ft.	3.3 ft.	6.7 ft.	Max Head	Amp Draw	0 ft.	3.3 ft.	6.7 ft.	Max Head	Fuse Size	Hose Size
HD1700	12	5.7	1700	1300	950	12 ft.	5.1	1500	1100	800	11 ft.	10-amp	1-1/8" I.D.
HD2000	12	6.6	2000	1600	1230	17 ft.	6	1800	1500	1200	16 ft.	12-amp	1-1/8" I.D.
	24	3.5	2000	1600	1230	17 ft.	2.9	1800	1500	1200	16 ft.	7-amp	1-1/8" I.D.

## HD1700 Pump

The perfect upgrade from 1500 GPH rated pumps... especially older, over-rated designs. Easily replaces 2000 GPH rated pumps. Delivers a true 1700 GPH at open flow while drawing less than 6-amperes.

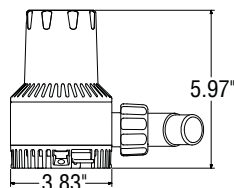

HD 1700 Pump with Anti-Airlock nozzle



Model No.	Rated Voltage	Wire/ Connector	Bulk Packaging	Aftermarket Packaging**
HD1700	12-Volt, CE rated	36" wire	4730-1	4730-4

## HD2000 Pump

Attwood's highest capacity bilge pump! Ball-bearing design provides for cooler motor operation and longer life. Delivers over 2000 GPH at open flow while drawing less than 7-amperes.

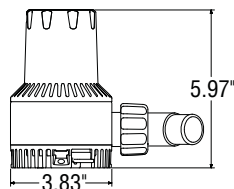

HD 2000 Pump with Anti-Airlock nozzle



Model No.	Rated Voltage	Wire/ Connector	Bulk Packaging	Aftermarket Packaging**
HD2000	12-Volt, CE rated	36" wire	4760-1	4760-4
	24-Volt, CE rated	36" wire	4770-1	4770-4

\*\* Individual Carton

BILGE PUMPS

# TSUNAMI BILGE PUMPS

With their innovative engineering and compact design, Tsunami pumps deliver high output from a small package. We use the most advanced material available, including the best quality bearings and state-of-the-art brushes, alloys and magnets. Our patented shaft seal prevents leaks caused by misalignment and our caulked and tinned wiring eliminates wicking, prevents water damage and resists corrosion.



## NMMA Numbers

Part No.	NMMA No.	IMCI (CE) Certificate No.
4606 Series	2456898	PATT042
4608 Series	2456899	PATT043
4609 Series	2456900	PATT044
4612 Series	2456901	PATT046
4613 Series	2456902	PATT045

## Pump Dimensions

Model No.	A	B	C	D	E
T500	2-3/4"	2-7/8"	3-5/8"	3/4" I.D.	3-1/8"
T800	3-1/8"	3-1/4"	4-3/8"	3/4" I.D.	3-1/2"
T1200	3-1/8"	3-1/4"	4-3/8"	1-1/8" I.D.	3-3/4"

## Specifications

GPH Output @ Design Voltage 13.6 VDC							GPH Output @ Nominal Voltage 12.0 VDC						
Model No.	Rated Voltage	Amp Draw	0 ft.	3.3 ft.	6.7 ft.	Max Head	Amp Draw	0 ft.	3.3 ft.	6.7 ft.	Max Head	Fuse Size	Hose Size
T500	12	1.8	600	440	260	9 ft.	1.4	550	360	160	8 ft.	3-amp	3/4" I.D.
T800	12	3	800	660	540	13 ft.	2.5	760	600	400	11 ft.	4-amp	3/4" I.D.
	24	1.3	800	660	540	13 ft.	1.1	760	600	400	11 ft.	2-amp	3/4" I.D.
T1200	12	3.5	1200	900	700	11 ft.	3	1100	810	480	9 ft.	5-amp	1-1/8" I.D.
	24	1.5	1200	900	700	11 ft.	1.3	1100	810	480	9 ft.	2-amp	1-1/8" I.D.

## Tsunami Bilge Pumps & Accessories

No mounting brackets necessary.

Model No.	Outlet Style	Rated Voltage	Wire/Connector	Bulk Packaging	Aftermarket Packaging**
<b>TSUNAMI BILGE PUMPS</b>					
T500	Barbed - 3/4"	12-volt	29" wire	<b>4606-1</b>	<b>4606-7</b>
	Threaded - 3/4"Δ	12-volt	29" wire	<b>4606TH1</b>	—
T800	Barbed - 3/4"	12-volt	29" wire	<b>4608-1</b>	<b>4608-7</b>
	Threaded - 3/4"Δ	12-volt	29" wire	<b>4608TH1</b>	—
	Barbed - 3/4"	24-Volts	29" wire	<b>4609-1</b>	—
T1200	Barbed - 1-1/8"	12-volt	29" wire	<b>4612-1</b>	<b>4612-7</b>
	Barbed - 1-1/8"	24-Volts	29" wire	<b>4613-1</b>	—
<b>TSUNAMI REPLACEMENT MOTOR CARTRIDGES</b>					
T500		12-volt	29" wire	—	<b>4620-6</b>
T800		12-volt	29" wire	—	<b>4622-6</b>
		24-Volts	29" wire	<b>4623-1</b>	—
T1200		12-volt	29" wire	—	<b>4624-6</b>
		24-Volts	29" wire	<b>4625-1</b>	—

Δ Threaded outlet permits the use with 90° fittings or Flow-Rite™ connectors.  
\*\* -6 = Blister, -7 = Clamshell

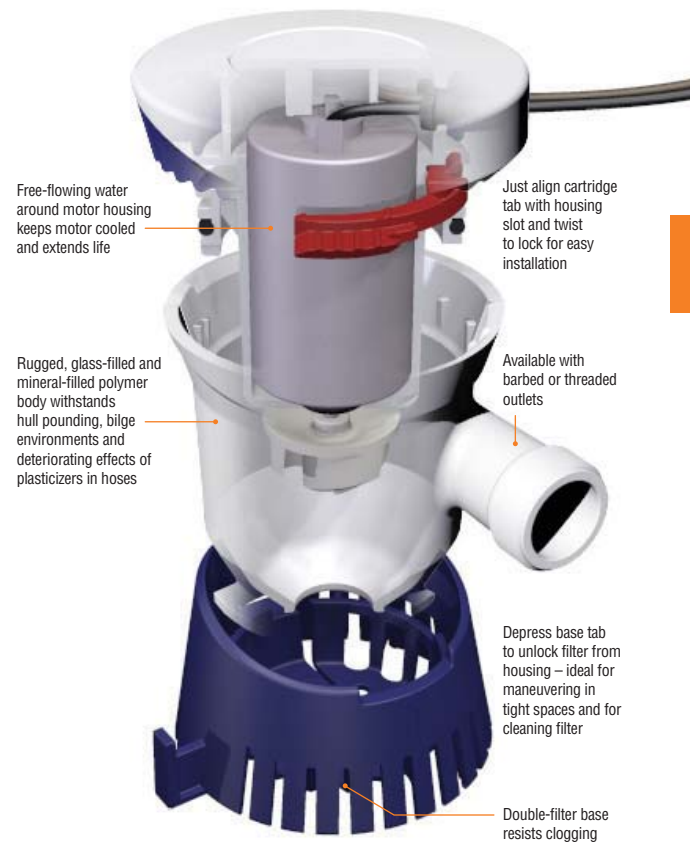

BILGE PUMPS

WATER SYSTEMS & VENTILATION

7

# TSUNAMI AERATOR PUMPS

With their innovative engineering and compact design, Tsunami pumps deliver high output from a small package. We use the most advanced material available, including the best quality bearings and state-of-the-art brushes, alloys and magnets. Our patented shaft seal prevents leaks caused by misalignment and our caulked and tinned wiring eliminates wicking, prevents water damage and resists corrosion.

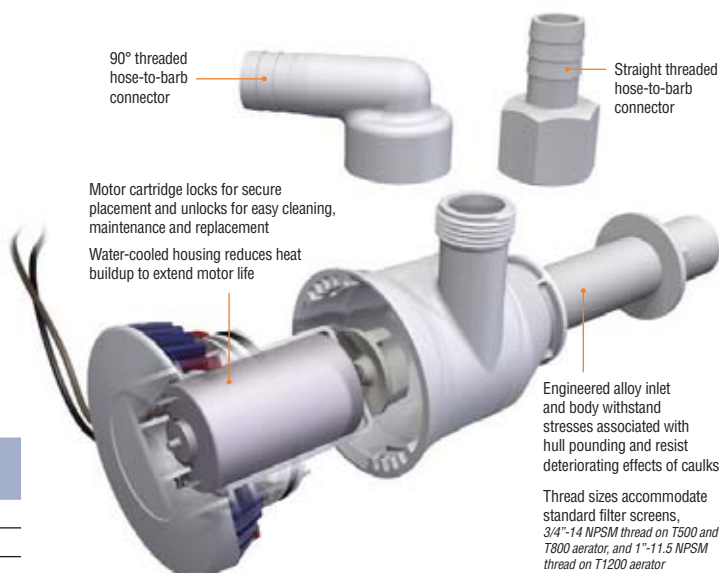

## NMMA Numbers

Part No.	NMMA No.	IMCI (GE) Certificate No.
4640 Series	2456903	IGPATT002
4650 Series	2456904	IGPATT003
4660 Series	2456905	IGPATT004

## Pump Dimensions

Model	Application	A	B	C	D	E	F	G
T500	Thru-Hull	3-1/2" or 1-1/2"	3" or 1"	3-1/4"	2-7/8"	3-5/8"	3/4-14 NPSM	3/4-14 NPSM
	Seacock	1-1/2"	1"	3-1/4"	2-7/8"	3-5/8"	3/4-14 NPT	3/4-14 NPSM
T800	Thru-Hull	3-1/2" or 1-1/2"	3" or 1"	3-7/8"	3-1/4"	4"	3/4-14 NPSM	3/4-14 NPSM
	Seacock	1-1/2"	1"	3-7/8"	3-1/4"	4"	3/4-14 NPT	3/4-14 NPSM
T1200	Thru-Hull	3-1/2" or 1-1/2"	3" or 1"	4"	3-1/4"	4-7/8"	1-3/8-12 UNF	1-3/8-12 UNF
	Seacock	1-1/2"	1"	4"	3-1/4"	4-7/8"	1-11-1/2 NPT	1-3/8-12 UNF

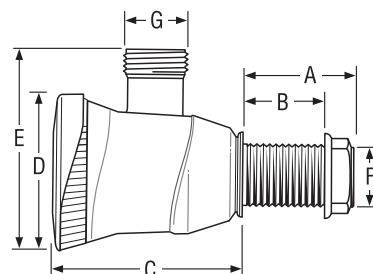

## Specifications

GPH Output @ Design Voltage 13.6 VDC							GPH Output @ Nominal Voltage 12.0 VDC						
Model No.	Rated Voltage	Amp Draw	0 ft.	3.3 ft.	6.7 ft.	Max Head	Amp Draw	0 ft.	3.3 ft.	6.7 ft.	Max Head	Fuse Size	Hose Size
T500	12	1.8	600	440	260	9 ft.	1.4	550	360	160	8 ft.	3-amp	3/4" I.D.
T800	12	3	800	670	525	9 ft.	2.5	750	555	370	8 ft.	4-amp	3/4" I.D.
T1200	12	3.5	1200	840	570	9 ft.	3	1140	790	450	8 ft.	5-amp	1-1/8" I.D.

## Tsunami Aerator Pumps & Accessories

No mounting brackets necessary.

Model No.	Inlet Length & Diameter	Outlet Style & I.D. Diameter	Rated Voltage	Wire/ Connector	Bulk Packaging	Aftermarket Packaging**
<b>TSUNAMI AERATOR PUMPS</b>						
T500	3-1/2" L x 3/4"	Threaded - 3/4"	12-volt	29" wire	4640-1	4640-7
	1-1/2" L x 3/4"	Threaded - 3/4"	12-volt	29" wire	4641-1	—
	7/8" L x 3/4"	Threaded - 3/4"	12-volt	29" wire used with 3/4" seacock	4643-1	4643-7
T800	3-1/2" L x 3/4"	Threaded - 3/4"	12-volt	29" wire	4650-1	4650-7
	1-1/2" L x 3/4"	Threaded - 3/4"	12-volt	29" wire	4651-1	—
	7/8" L x 3/4"	Threaded - 3/4"	12-volt	14' wire leads with cigarette adapter	4651CIG1	—
T1200	1-1/2" L x 3/4"	Threaded - 3/4"	12-volt	14' wire leads used with 3/4" seacock	4653-1	—
	3-1/2" L x 1-1/8"	Threaded - 1-1/8"	12-volt	29" wire	4660-1	4660-7
	3-1/2" L x 1-1/8"	Threaded - 1-1/8"	12-volt	14' wire leads with cigarette adapter	4660CIG1	—
	1-1/2" L x 1-1/8"	Threaded - 1-1/8"	12-volt	29" wire	4661-1	—
	7/8" L x 1"	Threaded - 1-1/8"	12-volt	29" wire used with 1" seacock	4663-1	—
<b>TSUNAMI REPLACEMENT MOTOR CARTRIDGES</b>						
T500			12-volt	29" wire	—	4620-6
T800			12-volt	29" wire	—	4622-6
			24-Volts	29" wire	4623-1	—
T1200			12-volt	29" wire	—	4624-6
			24-Volts	29" wire	4625-1	—



\*\* -6 = Blister, -7 = Clamshell

## AERATOR PUMPS

# TSUNAMI DUAL OUTLET AERATOR PUMPS

The advantage of the dual outlet is that you can feed multiple applications through a single thru-hull fitting. The Tsunami second outlet is integrated into the pressure chamber, so it looks – and pumps – like part of the aerator. Both of the pump's outlets are engineered for the precise position and angle that will deliver optimum performance.

## Applications:

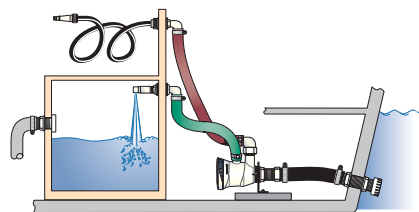

Rinse Hose plus Livewell

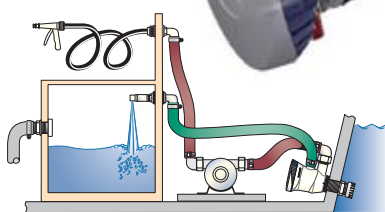

High Pressure Washdown plus Livewell

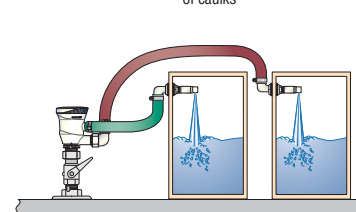

Supply Two Livewells

**3**  
YEAR  
WARRANTY

90° threaded  
hose-to-barb  
connector

Straight threaded  
hose-to-barb  
connector

Motor cartridge locks for secure  
placement and unlocks for easy  
cleaning, maintenance and  
replacement

Water-cooled housing reduces heat  
buildup to extend motor life

Thread sizes accommodate standard  
filter screens, 3/4"-14 NPSM thread on  
T500 and T800 aerator, and 1"-11.5 NPSM  
thread on T1200 aerator

Engineered alloy inlet and  
body withstand stresses  
associated with hull pounding  
and resist deteriorating effects  
of caulks

## NMMA Numbers

Part No.	NMMA No.	IMCI (CE) Certificate No.
4672	Pending	IGPATT003
4670	Pending	IGPATT003

## Pump Dimensions

Part No.	Inlet Length	Inlet Dia.	A	B	C	D	E	F	G	H
4672	3-1/2"	3/4"	3-1/4"	3"	4-1/8"	4-1/4"	4"	3/4-14 NPSM	3/4" Barbed .554" I.D.	3/4-14 NPSM .620" I.D.
4670	3/4"	3/4"	1-1/4"	7/16"	4-1/8"	4-1/4"	4"	3/4-14 NPT	3/4" Barbed .554" I.D.	3/4-14 NPSM .620" I.D.

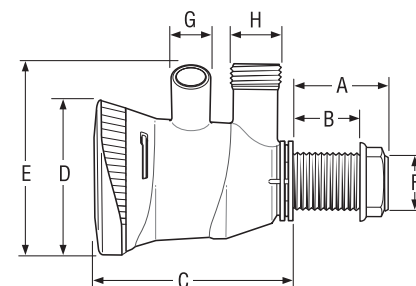

## Specifications

GPH Output @ Design Voltage 13.6 VDC							GPH Output @ Nominal Voltage 12.0 VDC						
Both Outlets Open							Both Outlets Open						
Outlet	Amp Draw	0 ft.	3.3 ft.	6.7 ft.	Max Head	0 ft.	Amp Draw	0 ft.	3.3 ft.	6.7 ft.	Max Head	0 ft.	Fuse Size
Upper	3.0	750	600	460	13 ft.	880	2.5	670	500	390	11 ft.	770	4-amp
Lower	3.0	750	620	480	13 ft.	880	2.5	690	550	420	11 ft.	770	4-amp

## Tsunami Dual Outlet Aerator Pumps & Accessories

No mounting brackets necessary.

Model No.	Inlet Length & Diameter	Rated Voltage	Wire/Connector	Bulk Packaging	Aftermarket Packaging**
<b>TSUNAMI DUAL OUTLET AERATOR PUMPS</b>					
T800	3-1/2" L x 3/4"	12-volt	29" wire	<b>4672-1</b>	<b>4672-7</b>
	7/8" L x 3/4"	12-volt	29" wire, use with 3/4" seacock	<b>4670-1</b>	<b>4670-7</b>
<b>TSUNAMI REPLACEMENT MOTOR CARTRIDGE</b>					
T800		12-volt	29" wire	—	<b>4622-6</b>



\*\* -6 = Blister, -7 = Clamshell

AERATOR PUMPS

WATER SYSTEMS & VENTILATION

9

## S3 SERIES AUTOMATIC BILGE SWITCHES

Incorporates a proprietary Electronic Sensing technology to detect bilge water levels and trigger pump activation and has been engineered to operate in any bilge water mixture consistently without failure. Your pump won't be exposed to continuous cycling as the S3 switch can easily distinguish splashing bilge water, chemicals, sludge build up or foam and comes equipped with fully sealed electronics that are completely protected from water or chemical damage. For added convenience, the bilge switch can be mounted on the floor of the bilge directly to a stringer wall or alongside the basket of the pump without added components or brackets. The S3 Series switch is also directly compatible with all competitive products and free of moving parts that can jam up, break or wear out over time.

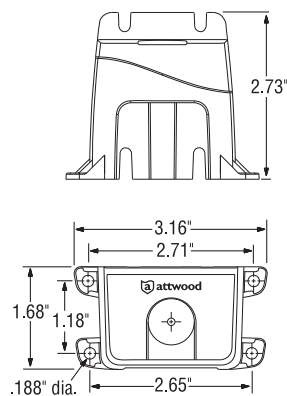

Description	Max. Pump Amp Draw	Rated Voltage	Wire	Bulk Packaging	Aftermarket Packaging**
Switch, White	15A	12-volt	36" wire	4801-1	4801-7
Switch, Dark Gray	10A	24-Volts	36" wire	4802-1	4802-7

## Automatic Float Switches

Converts bilge pumps to fully automatic operation. Maximum amp draw is 12 amps (at 12-volt D.C.) or 6-amps (at 24-Volts D.C.). Features a compact, low-profile design that mounts on any surface from horizontal up to a 24° angle. Incorporates a reliable and affordable mechanical switch that actuates pump motor at 2" water level. Wire leads do not flex or hinge with the float as on some competitive models. Integral cover dampens bilge sloshing to reduce pump cycling, and prevents debris interference. Sealed switch mechanism resists moisture, fume-ignition, and electrical shock. Contains no mercury, which is listed as a health hazard and "Persistent Toxic Substance" in over 26 states.

### IMCI Certificate Numbers

Part No.	IMCI (CE) Certificate No.
4201 Series	IGPATT001
4202 Series	IGPATT001

Float switch installs directly onto the rear slots of the V-Series pump bracket.  
Features a convenient test knob to test pump operation.

### Float Switch with Cover

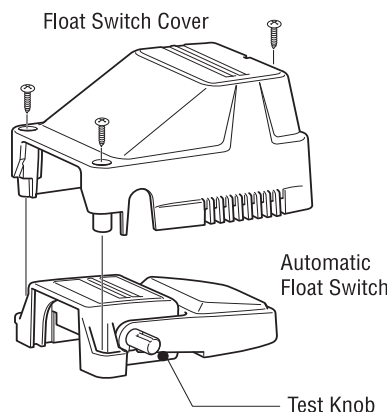
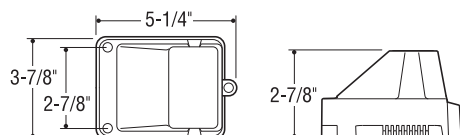

Description	Rated Voltage	Wire/Connector	Bulk Packaging	Aftermarket Packaging**
Float switch with cover	12- and 24-Volts, CE rated	36" wire	4201-1	4201-7
Float switch cover only	—	—	—	911844-7



### Float Switch

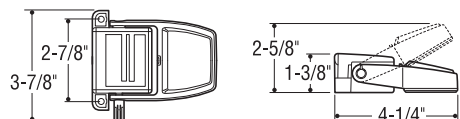

Description	Rated Voltage	Wire/Connector	Bulk Packaging	Aftermarket Packaging**
Float switch	12- and 24-Volts, CE rated	36" wire	4202-1	4202-7



\*\* -7 = Clamshell

## BILGE AND FLOAT SWITCHES



# Shower Sump Pump Systems

Attwood's shower sump systems deliver the performance you've been asking for. Choose from Standard Box or Large Box sizes. Offering fast water flow into and out of sump. The lid snaps in to allow quick installation (and removal for cleaning) and includes a gasket to seal the sump box against overflow. The sump box even includes an air vent to prevent air locks. Meets or exceeds all applicable standards of the ABYC and USCG.

## Specifications

Model	Rated Voltage	Fuse Size	Outlet Hose Size
500 GPH	12-volt	3-amps	3/4" I.D.
750 GPH	12-volt	5-amps	3/4" I.D.
750 GPH	24-volts	2-amps	3/4" I.D.

## Output Ratings

Model	Amp Draw	GPH Output @ Design Voltage 13.6 VDC			GPH Output @ Nominal Voltage 12.0 VDC		
		0 ft.	3.3 ft.	6.7 ft.	0 ft.	3.3 ft.	6.7 ft.
500 GPH	1.4	420	360	215	385	290	130
750 GPH	2.5	650	500	385	570	420	290

Performance for 24-Volt version is the same (Uses 2 Amp Fuses)

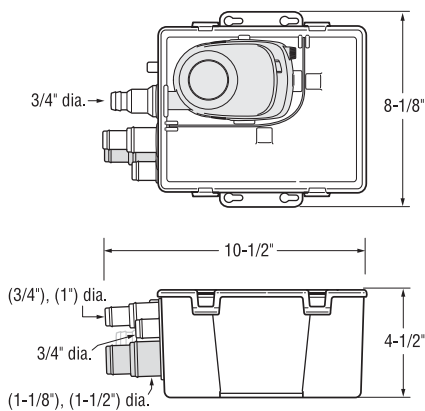

Standard Box

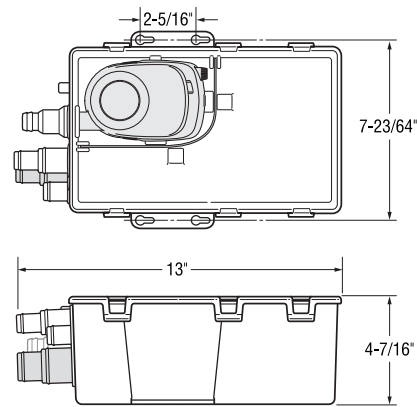

Large Box

Multiple Inlets Can Be Hooked Up to More Than One Drain – Using Different Hose Sizes

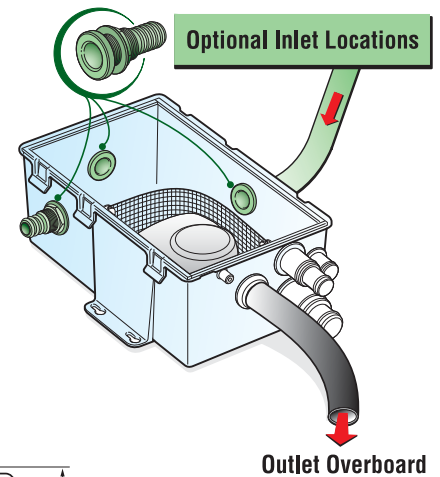
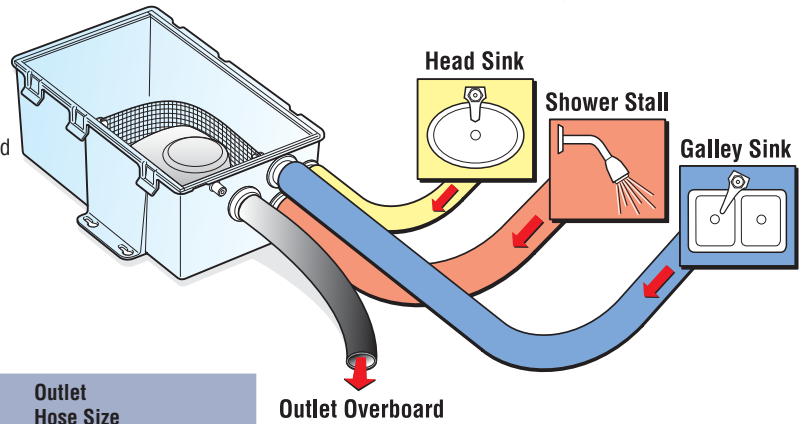

Model No.	Rated Voltage	Wire/Connector	Box Size	Bulk Packaging	Aftermarket Packaging**
500 GPH	12-volt	22" wire	Standard	4141-1	4141-4
750 GPH	12-volt	22" wire	Standard	4142-1	—
750 GPH	12-volt	22" wire	Large	4143-1	4143-4
750 GPH	24-Volts	22" wire	Large	4144-1	—
750 GPH	24-Volts	22" wire	Standard	4145-1	—



4141



4143

\*\* -4 = Individual Carton

SHOWER AND WASHDOWN SYSTEMS

WATER SYSTEMS & VENTILATION

11

## Aft-Deck Shower

Install flush in the transom or under the gunwale. Includes hinged cover and replaceable sprayer head. Fixtures are corrosion-resistant. Housing and cover are made of high-impact, UV resistant, engineering-grade plastic and are pre-drilled for six #8 fasteners. Comes with 6' hose, shut-off, and hot/cold mixing controls. Connects to freshwater system for showering.

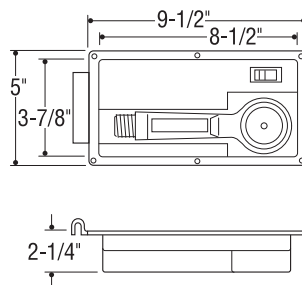

Description	Function	Hose Length	Bulk Packaging	Aftermarket Packaging**
Aft-Deck	Hot/cold	6'	4131-1	4131-4

## Cold Water Shower

Install flush in the transom or under the gunwale. Includes hinged cover and replaceable sprayer head. Fixtures are corrosion-resistant. Housing and cover are made of high-impact, UV resistant, engineering-grade plastic and are pre-drilled for six #8 fasteners. Hand-held shower sprayer with 6' hose and shut-off. Connects to freshwater system or self-priming wash-down pump for showering after swimming. Built-in on/off switch for pump.

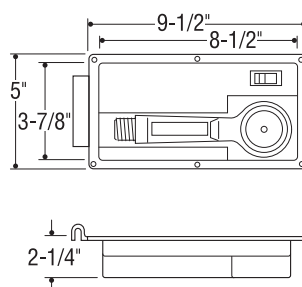

Description	Function	Hose Length	Bulk Packaging	Aftermarket Packaging
Cold water	On/off switch	6'	4133-1	—

## Self-Priming Washdown Pump

Self-priming pump for cleaning boats, general use, or use as a shower pump. Threaded male inlet and outlet for standard garden hose attachment. Pumps 4 gallons per minute, produces up to 8.5 PSI pressure. Corrosion-resistant plastic housing and impeller, heavy-duty 8-amp 12-Volt D.C. motor. **Note:** Do not run dry.



Description	Open Flow GPM	Max Head Pressure	Bulk Packaging	Aftermarket Packaging**
Self-priming	4	8.5 PSI	—	11574-4

## Potable Water Pump

This economical, compact pump delivers drinking water from a water tank to the 6142 Three-Way Faucet/Hand Pump. Seal allows it to run dry without damage. Made from high-impact plastic. Patented. Inlet and outlet have combination fittings: 3/8" barbs can be removed to accommodate 1/4" NPT fitting. Potable Water Pump is not activated by line pressure. Pump is non-submersible. Note: Mount centrifugal pump so water will flow into the pump. **Caution:** Not external ignition protected.

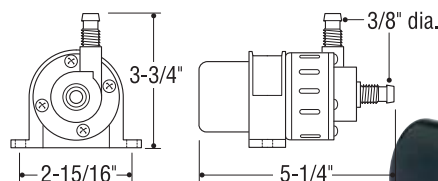

Inlet/Outlet Size	GPH	Max Head	Amp Draw	Fuse Size	Bulk Packaging	Aftermarket Packaging**
3/8" barb, or convert to 1/4" NPT	150	16'	1.5	2-amp	6126-1	6126-7

\*\* -4 = Individual Carton, -7 = Clamshell

### SHOWER AND WASHDOWN SYSTEMS

# Faucet and Hand Pumps

High-impact plastic. Use as a 2-way hand-operated pump in a self-contained water system or as an ordinary faucet in a pressurized system. For 1/2" female pipe thread fitting. Use as a 3-way manual, pressurized, or electric 12-Volt D.C. drinking water faucet with 6126 Potable Water Pump. Delivers water immediately. Includes adapters for 3/8" I.D. hose or 1/4" tapered male pipe thread fitting. Single fixture eliminates need for separate faucets on separate water systems.

## Specifications

Part No.	Description	Inlet Size	Fitting
6143	2-way	1/2" I.D. or 3/8" I.D.	Barbed
6144	2-way	1/2" I.D. or 1/4 NPT	Compression
6142	3-way electric	1/2" I.D., 3/8" I.D. or ZV" NPT	Compression

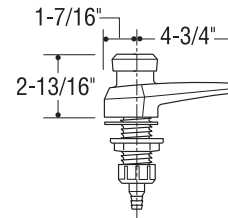

6143



6142

Description	Bulk Packaging	Aftermarket Packaging**
2-way with 3/8" barbed fitting	6143-1	—
2-way with 1/4" compression fitting	6144-1	—
3-way electric with 3/8" and 1/4" adapters	—	6142-5

## Faucet Repair Kit

Includes replacement knob pin, two flapper valves, stainless disk, plus all gaskets and seals.

Description	For Use With	Bulk Packaging	Aftermarket Packaging**
Faucet repair kit	6142, 6143, 6144	—	6127-3



6127

## WATERBUSTER® PORTABLE PUMP

This submersible pump is a great way to remove unwanted water from boats, pool covers, aquariums and sump pits. Convenient and safe because it needs no electrical cord — runs up to 5 hours on three alkaline "D"-batteries. Excellent for use as a portable pump-out device for paddle boats, inflatables, duck boats, dingies or kayaks, any craft that lacks a hard-wire, permanent electrical system.

- 6-3/8" high x 5-1/4"-diameter.
- Pumps up to 200 gallons per hour
- Includes 42" hose with garden hose adapter for adding longer hose
- Lifts water to height of 40".
- **Note:** Not to be used as a permanent bilge pump.

Description	GPH Open Flow	GPH 2 ft. Head*	Bulk Packaging	Aftermarket Packaging**
Portable Pump	200	125	—	4140-4



4140

## Hand-Operated Bilge Pumps

Safely remove unwanted water, or other liquids, from kayaks and other small boats.

new

Description	Bulk Packaging	Aftermarket Packaging**
Kayak Hand Bilge Pump, 18"	—	11595-2
Hand Bilge Pump, 25", 32" Hose	—	11596-2



11595

11596

\* 4 ft. maximum head

\*\* -3 = Skin Pack, -4 = Individual Carton, -5 = Poly Bag

HAND OPERATED PUMPS

# Bilge Pump Switches

Panel-mounted rocker switches for use with pump that draws 10-amperes or less. 1/4" spade terminals. 6-Volt through 32-Volt D.C. only, 10-amperes maximum. Plate is 2-13/16" x 1-7/8". Hole size is 1-1/2" x 7/8".

**Caution:** Bilge pump switches are not external ignition protected.

Description	Bulk Packaging	Aftermarket Packaging**
2-way on/off	—	7615-3
3-way auto/off/manual	—	7615A3



7615

# Livewell Aerator Switch

Provides on/off or cycling of aerator pump to extend battery life. Solid-state cycle module switches pump to on, or to a run time of 30 seconds on/3 minutes off. Includes face plate for panel mounting. For 12-Volt D.C. 10-amp maximum only.

- 1-1/4" long x 1-1/4" wide
- Installation hole size: 1/2"-diameter
- Depth behind panel: 3-1/4" deep

Description	Bulk Packaging	Aftermarket Packaging**
Three position switch on/off/cycle	—	14292-3



14292

# TSUNAMI RECIRQ AERATOR KIT

The Tsunami Recirq Kit recirculates livewell water to keep it cooler and rich in oxygen. This self-contained system feeds a separate aerator spray head and works even while you are underway and cannot use a thru-hull connection. Add this kit to any tank that already has a freshwater fill system. Or use as a backup pump for a fail-safe system.

**Recirq Kit includes:**

- (1) 500 GPH Tsunami aerator pump with short inlet, threaded outlet
- (1) 4125-1 aerator spray head
- (1) 4232-1 Stainless Steel strainer
- (2) Plastic hose clamps
- (1) 3/4" dia., 23" L poly hose
- (1) Straight thread-to-barb connector

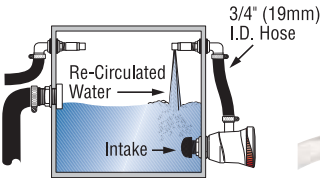

4253

Description	Bulk Packaging	Aftermarket Packaging**
T-500 Recirq Livewell Aerator Kit	—	4253-7

# Bilge Pump Installation Kits

Complete kit to install manual bilge pump with 3/4" I.D. hose outlet.

- (1) 2-way on/off switch with bezel plate
- (1) 3/4" I.D. x 5' corrugated hose
- (1) Thru-hull fitting for 3/4" I.D. hose
- (2) Snap-It hose clamps
- (1) 2-conductor 16-gauge wire, 20' long
- (1) In-line fuse holder with 2-amp fuse

**Caution:** Bilge pump switches are not external ignition protected.

Description	Hose Size	Bulk Packaging	Aftermarket Packaging**
Complete kit	3/4" I.D.	—	4116-5
Complete kit with Tsunami T-500 bilge pump	3/4" I.D.	—	4614-7
6' hose with (2) clamps	3/4" I.D.	—	4199-7
6' hose only	1-1/8" I.D.	—	11551-5



4116



4614

\*\* -3 = Skin Pack, -5 = Poly Bag, -7 = Clamshell



## Aerator Remote Mounting Brackets

For mounting the aerator pump to a base, away from the transom.

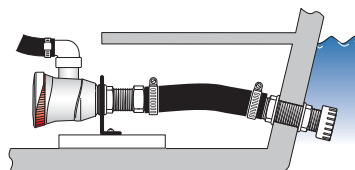

Description	Bulk Packaging	Aftermarket Packaging**
1-1/8" Aerator remote mounting bracket	4121-1	4121-3
3/4" Aerator remote mounting bracket	4122-1	4122-3



## Aerator Spray Heads

For use on livewells that have built-in overflows or recirculating systems.

**Adjustable Spray Heads** - Mounts on sides of tank. 90° fitting for installation in tight spaces. Rotating head with O-ring adjusts and maintains flow setting. Removable head has an "interference-fit thread design" that will not allow it to vibrate or blow out. Polypropylene construction. Can be installed on tanks with up to 5/8" wall thickness.

**Non-Adjustable Spray Heads** - Multi-port spray maximizes oxygen level in the livewell. Constructed of ABS plastic.

**Double Valve Spray Head** - Allows aerating options – one end can be used for freshwater fill, the other end with a recirculating pump. **Single Valve Spray Head** - For output from an aerator pump into the livewell.

Description	Hose I.D.	Bulk Packaging	Aftermarket Packaging**
<b>ADJUSTABLE SPRAY HEADS</b>			
Aerator spray head	3/4"	4125-1	4125-7
Aerator spray head w/male connector for Flow-Rite™ Qwik-Lok™ Coupler 3	3/4"	4123-1	—
Aerator spray head for use w/ 1-1/8" I.D. Hose	1-1/8"	4127-1	4127-3
<b>NON-ADJUSTABLE SPRAY HEADS</b>			
Aerator spray head, single valve	3/4"	4118A1	4118A5
Aerator spray head, dual valve	3/4"	4118-1	4118-5

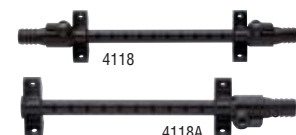

## Check Tees

These check tees replace additional connections for RV and marine hookups, providing a combination check valve and tee that allows water to flow in from the dockside connection without filling the tank. Constructed of ABS plastic.

**Combination Barbed Fitting** - Inlet and outlet have combination fittings: Comes with 3/8" barbs that can be removed to accommodate 1/4" NPT fitting. 1/2" NPT fitting for dockside water connection.

**Combination Barbed Inlet/Threaded Outlet** - Inlet has combination fitting: Comes with 3/8" barbs that can be removed to accommodate 1/4" NPT fitting. Outlet is 1/2" NPSM. 1/2" NPT fitting for dockside water connection.

Description	Bulk Packaging	Aftermarket Packaging
Combination barbed fitting	6115-1	—
Combination barbed inlet/threaded outlet	6115A1	—



## Sealants

**Silicone Sealant** - Bonds to fiberglass, plastic, glass, and metal. 100% marine-grade silicone won't yellow. Can be used above and below the waterline.

**Polyurethane Sealant** - Bonds securely to fiberglass, plastic, glass, and metal. Fast cure formula.

Description	Bulk Packaging	Aftermarket Packaging**
Silicone Sealant, Clear, 2.8 oz.	—	30110-6
Polyurethane Sealant, White, 2.8 oz.	—	30106-6



\*\* -3 = Skin Pack, -5 = Poly Bag, -6 = Blister, -7 = Clamshell

# Snap-It Hose Clamps

Use on bilge pumps and shower sump systems. Corrosion-resistant plastic.

**Note:** Clamps are intended for water and waste system hoses only.

Description	Bulk Packaging	Aftermarket Packaging
For 7/8" to 1" O.D. hose (3/4 I.D.)	9185J1	—
For 1-3/16" to 1-7/16" O.D. hose (1-1/8 I.D.)	9185M1	—



9815M

## Tees

Three-way 90° fitting. Acetal construction.

Description	Bulk Packaging	Aftermarket Packaging
For 3/4" I.D. hose	3892-1	—
For 1-1/8" to 1-1/4" I.D. hose	3893-1	—



3892

## Elbows

Two-way 90° fitting. 3894 is acetal construction, 3895 is polypropylene construction.

Description	Bulk Packaging	Aftermarket Packaging
For 3/4" I.D. hose. For use with 500-800 gph pumps	3894-1	—
For 1-1/8" to 1-1/4" I.D. hose. For use with 1200 gph pumps	3895-1	—



3894

## Straight Connectors

Threaded end fits 3888 drain fitting, A-Series aerator pump outlets and Tsunami threaded outlets. Acetal construction.

**3899:** Barbed end accommodates 3/4" I.D. hose.

**3909:** Male end accommodates Flow-Rite™ Qwik-Lok™ Coupler.

Description	Bulk Packaging	Aftermarket Packaging**
Thread-to-Barb 3/4"-14 NPSM and 3/4" I.D. hose fitting. For use with 500-800 gph pumps	3899-1	3899-3
Thread-to-Flow-Rite™ Qwik-Lok™ Connector fitting. For use with 500-800 gph pumps	3909-1	—
Thread-to-Barb Straight 1-3/8" - 12 UNF thread & 1-1/8" hose fitting For use with 1200 gph pumps	3902-1	3902-3
Thread-to-Flow-Rite™ Qwik-Lok™ Connector 1-1/8" hose fitting	3911-1	—



3899

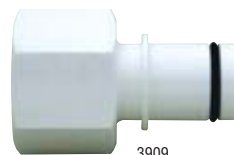

3909



3902



3911-1

## 90° Connectors

**3890:** Threaded female end fits 3888 drain fitting or A-Series aerator pump outlets and Tsunami threaded outlets. Barbed end accommodates 3/4" I.D. hose. Acetal construction.

**3900:** Threaded end fits A-Series aerator pump outlets and Tsunami threaded outlets. Male end accommodates Flow-Rite™ Qwik-Lok™ Coupler.

**3891:** Threaded end fits 3889 drain fitting. High-impact plastic. Barbed end accommodates 1-1/8" or 1-1/4" I.D. hose. Acetal construction.

Description	Bulk Packaging	Aftermarket Packaging**
For 3/4"-14 threads and 3/4" I.D. hose. For use with 500-800 gph pumps	3890-1	3890-3
Thread-to-Flow-Rite™ Qwik-Lok™ Connector. For use with 500-800 gph pumps	3900-1	—
For 1-3/8"-12 threads and 1-1/8" or 1-1/4" I.D. hose. For use with 1200 gph pumps	3891-1	—



3890



3900



3891

\*\* -3 = Skin Pack, -5 = Poly Bag, -7 = Clamshell

# STAINLESS STEEL THRU-HULLS & SCUPPER VALVE FITTINGS

Polish your image with these beautiful, durable stainless steel fittings. Each Thru-Hull and Scupper Valve is available with a new silicone gasket and are backed by Attwood's trusted Lifetime Warranty! Why specify plastic parts when these fittings will last the life of the boat?

## Rugged Stainless Construction

- Cast from certified enhanced #316 Stainless Steel alloy for strength and lifetime corrosion-resistance
- We polish all visible areas to a mirror finish, then each part through passivation for additional protection
- Thick steel sidewalls withstand continual stress and hose flexing

## Solid Silicone Gasket

- Gasket is dimensionally stable — will not deteriorate or shrink over time
- Excellent resistance to UV & weather-aging
- Watertight, fool-proof, one-piece seal
- Eliminates the need to form and apply sealant or caulk
- No more chemicals, solvent-soaked rags, or cleanup
- More than pays for itself in saved labor and cleanup time
- Guaranteed good looks because the perfect fit and concealment is built into the gasket

## Faster, Simpler Installation

- A channel under the flange holds a bead of sealant, making it easier to apply a trouble-free seal
- All models have wrench flats or an end notch to hold as a gripping surface. One installer can tighten all connections from inside the hull
- Barbed tail ends provide plenty of room to hold multiple clamps

## Stainless Steel Straight Thru-Hulls, Barbed

- Standard Thread model has full-length thread for thick hulls and easy tightening
- Short Thread is a more compact size. Allows installation near corners and in confined areas.

**Caution:** Stainless Steel Thru-Hull Connectors are designed for installation above the water line only.

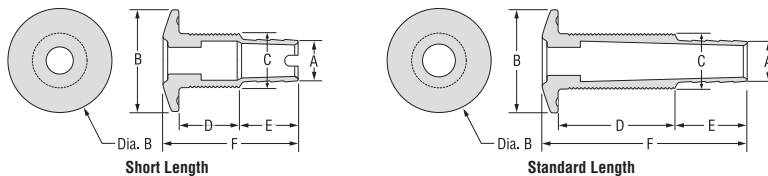

A Hose Size	B Flange Dia.	C Thread O.D.	D Thread Length	E Barb Length	F Total Length	Install. Hole Saw Size	Thread NPSM	Max Hull Thick.	Bulk without Gasket	Bulk with Gasket	Aftermarket Packaging**
<b>SHORT LENGTH</b>											
5/8" I.D.	1-7/8"	1"	1"	1"	2-1/4"	1-1/8"	3/4"	5/8"	66540-1	66540G1	66540-3
3/4" I.D.	1-7/8"	1"	1"	1"	2-1/2"	1-1/8"	3/4"	5/8"	66541-1	66541G1	66541-3
1" I.D.	2-1/4"	1-3/8"	1-1/8"	1"	2-1/2"	1-1/2"	1"	5/8"	66542-1	66542G1	66542-3
1-1/8" I.D.	2-1/4"	1-3/8"	1-1/4"	1"	2-1/2"	1-1/2"	1"	5/8"	66543-1	66543G1	66543-3
1-1/4" I.D.	2-1/4"	1-5/8"	1-1/4"	1"	2-5/8"	1-3/4"	1-1/4"	5/8"	66544-1	66544G1	66544-3
1-1/2" I.D.	3"	1-7/8"	1-1/4"	1-1/2"	3-1/8"	2"	1-1/2"	5/8"	66545-1	66545G1	66545-3
<b>STANDARD LENGTH</b>											
5/8" I.D.	1-7/8"	1"	2"	1-1/4"	3-3/4"	1-1/8"	3/4"	1-1/16"	66546-1	66546G1	66546-3
3/4" I.D.	1-7/8"	1"	2"	1-1/4"	3-3/4"	1-1/8"	3/4"	1-5/8"	66547-1	66547G1	66547-3
1" I.D.	2-1/4"	1-3/8"	2-1/4"	1-1/4"	3-7/8"	1-1/2"	1"	1-3/4"	66548-1	66548G1	66548-3
1-1/8" I.D.	2-1/4"	1-3/8"	2-3/8"	1-1/4"	3-7/8"	1-1/2"	1"	1-3/4"	66549-1	66549G1	66549-3
1-1/4" I.D.	2-1/4"	1-5/8"	2-1/2"	1-1/4"	4-1/4"	1-3/4"	1-1/4"	1-7/8"	66550-1	66550G1	66550-3
1-1/2" I.D.	3"	1-7/8"	2-1/2"	1-1/4"	4-1/8"	2"	1-1/2"	1-7/8"	66551-1	66551G1	66551-3
2" I.D.	3"	2-3/8"	2-1/2"	1-3/4"	4-5/8"	2-1/2"	1-1/2"	2"	66552-1	66552G1	—

\*\* -3 = Skin Pack



STAINLESS STEEL THRU-HULLS & SCUPPER VALVE FITTINGS

WATER SYSTEMS & VENTILATION

17

# Stainless Steel Straight Thru-Hulls, Threaded

- Unique multi-thread design with NPSM and NPT threads
- Offer generous thread length
- Allows for direct connection to seacocks or pipes

**Caution:** Stainless Steel Thru-Hull Connectors are designed for installation above the water line only.

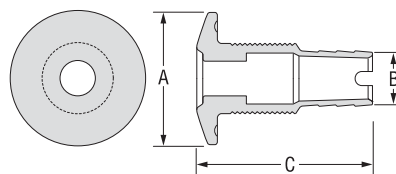

A Flange Dia.	B Thread O.D.	C Total Length	Installation Hole Saw Size	Threads NPSM	Max Hull Thickness	Bulk without Gasket	Bulk with Gasket	Aftermarket Packaging
1-7/8"	2-1/8"	2-1/2"	1-1/8"	3/4"	1-5/8"	66559-1	66559G1	—
2-1/4"	2-1/4"	2-5/8"	1-3/8"	1"	1-3/4"	66561-1	66561G1	—
3"	2-3/8"	2-3/4"	2"	1-1/2"	1-7/8"	66563-1	66563G1	—

# Stainless Steel 90° Thru-Hulls, Barbed

Allows installation in especially tight spaces.

**Caution:** Stainless Steel Thru-Hull Connectors are designed for installation above the water line only.

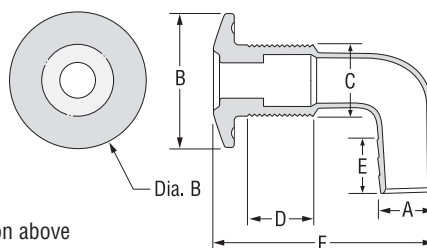

A Hose Size	B Flange Dia.	C Thread O.D.	D Thread Length	E Barb Length	F Total Length	Install. Hole Saw Size	Thread NPSM	Max Hull Thick.	Bulk without Gasket	Bulk with Gasket	Aftermarket Packaging
3/4" I.D.	1-7/8"	1"	1-1/2"	3/4"	3-3/8"	1-1/4"	3/4"	1-1/16"	66577-1	66577G1	—
1-1/8" I.D.	2-1/4"	1-3/8"	1-7/8"	3/4"	4-3/8"	1-5/8"	1"	1-1/4"	66579-1	66579G1	—

# Stainless Steel Scupper Valves

- The Scupper Flap is tough neoprene rubber with a molded V that fits into the grooved body to reduce backwash
- Fasteners are concealed and corrosion-proof

**Caution:** Stainless Steel Scupper Valves are designed for installation above the water line only.

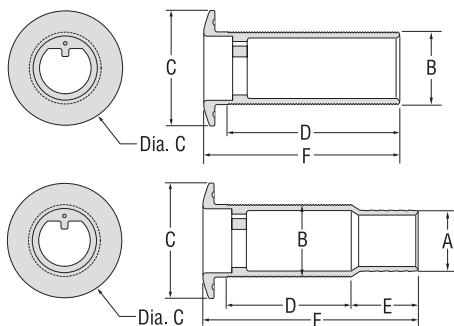

A Hose Size	B Flange Dia.	C Thread O.D.	D Thread Length	E Barb Length	F Total Length	Install. Hole Saw Size	Thread NPSM	Max Hull Thick.	Bulk without Gasket	Bulk with Gasket	Aftermarket Packaging**
<b>THREADED</b>											
—	1-7/8"	3"	3-1/2"	—	3-7/8"	2"	1-1/2"	3"	66565-1	66565G1	—
—	2-23/64"	3-5/8"	2-1/2"	—	2-7/8"	2-1/2"	2"	2"	66567-1	66567G1	—
<b>BARBED</b>											
1-1/2"	1-7/8"	3"	3-1/2"	1-1/2"	5-1/2"	2"	1-1/2"	3"	66553-1	66553G1	66553-3
2"	2-23/64"	3-5/8"	2-1/2"	1-5/16"	4-1/2"	2-1/2"	2"	2"	66555-1	66555G1	—
1-1/2"	1-7/8"	3"	2-1/4"	1-1/2"	4-1/2"	2"	1-1/2"	1-3/4"	66557-1	66557G1	—

\*\* -3 = Skin Pack

STAINLESS STEEL THRU-HULLS & SCUPPER VALVE FITTINGS



# Stainless Steel Narrow Flange Thru-Hulls

**LIFETIME  
WARRANTY**

- Consistent exterior appearance throughout a range of barb sizes
- Modern Styling
- Enhanced #316 Stainless Steel

**Caution:** Stainless Steel Thru-Hull Connectors are designed for installation above the water line only.

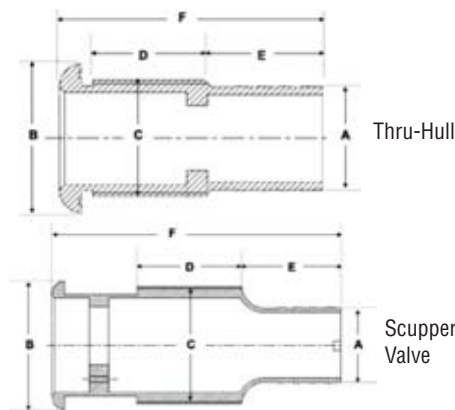

A Hose Size	B Flange Dia.	C Thread O.D.	D Thread Length	E Barb Length	F Total Length	Install. Hole Saw Size	Thread NPSM	Max Hull Thick.	Bulk without Gasket	Bulk with Gasket	Aftermarket Packaging
<b>THRU-HULLS, STANDARD LENGTH</b>											
5/8" I.D.	1-7/10"	1-3/10"	1-2/5"	1-1/8"	3"	1-5/16"	1"	7/8"	67555-1	67555G1	—
3/4" I.D.	1-7/10"	1-3/10"	1-3/10"	1-1/4"	3"	1-5/16"	1"	3/4"	67554-1	67554G1	—
1" I.D.	1-7/10"	1-3/10"	1-2/5"	1-1/8"	3"	1-5/16"	1"	7/8"	67556-1	67556G1	—
1-1/8" I.D.	1-7/10"	1-3/10"	1-1/4"	1-1/8"	2-7/8"	1-5/16"	1"	3/4"	67557-1	67557G1	—
1-1/2" I.D.	2-2/5"	1-7/8"	1-1/2"	1-3/5"	3-2/5"	2"	1-1/2"	1"	67551-1	67551G1	—
2" I.D.	3.13"	2-3/8"	2.93"	2.04"	6.09"	2-7/16"	2"	2.70"	67552-1	67552G1	—
<b>THRU-HULLS, LONG LENGTH</b>											
3/4" I.D.	1-7/10"	1-3/10"	1-1/2"	1-1/8"	4-1/4"	1-5/16"	1"	—	67558-1	—	—
1-1/8" I.D.	1-7/10"	1-3/10"	1-1/2"	1-1/8"	4-1/4"	1-5/16"	1"	—	67561-1	—	—
1-1/2" I.D.	2-2/5"	1-7/8"	1-1/2"	1-7/16"	4-15/16"	2"	1-1/2"	—	67562-1	—	—
<b>SCUPPER VALVE</b>											
1-1/2" I.D.	2-3/5"	1-7/8"	2"	2"	5-3/4"	2-1/8"	1-1/2"	2-3/4"	67553-1	67553G1	—



# Stainless Steel Exhaust Thru-Hulls

**LIFETIME  
WARRANTY**

- Specifically designed for generator and engine exhaust applications
- Features unique, modern styling that is both elegant and functional
- Stainless steel scupper valve and an integrated stainless drip ring

**Caution:** Stainless Thru-Hull Connectors are designed for installation above the water line only.

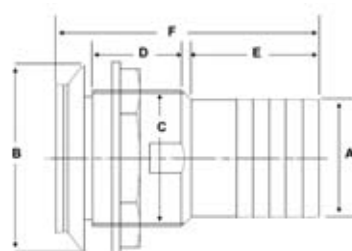

A Hose Size	B Flange Dia.	C Thread O.D.	D Thread Length	E Barb Length	F Total Length	Install. Hole Saw Size	Thread NPSM	Max Hull Thick.	Bulk without Gasket	Bulk with Gasket	Aftermarket Packaging
1-1/2" I.D.	3.18"	2.26"	1.6"	1.97"	4.58"	2.375"	2" – 11-3/4"	1.125"	67581-1	67581G1	—
2" I.D.	3.18"	2.26"	1.6"	2.23"	4.58"	2.375"	2" – 11-3/4"	1.125"	67580-1	67580G1	—
2-1/2" I.D.	4.60"	3.375"	1.8"	2.75"	5.8"	3.625"	3" – 8"	1.5"	67583-1	67583G1	—
3" I.D.	4.60"	3.375"	1.8"	3"	5.8"	3.625"	3" – 8"	1.5"	67582-1	67582G1	—



# STAINLESS STEEL CAPPED COMPOSITE THRU-HULLS

Designed for the value conscious customer, these fittings provide the look of a Stainless Steel thru-hull at a fraction of the cost

## Corrosion Resistance

Manufactured with high quality stainless steel caps and engineered composite bodies, these thru-hulls are designed to resist degradation as a result of chemical and saltwater exposure.

## Consistent Look

To create a uniform look, Attwood has designed its 5/8" thru 1 1/4" barbed thru hulls with a common exterior surface.

## Improved Installation

Always keeping the builder in mind, each fitting incorporates several different types of assembly features that allow for "single operator" installation.

**Caution:** Stainless Steel Thru-Hull Connectors are designed for installation above the water line only.

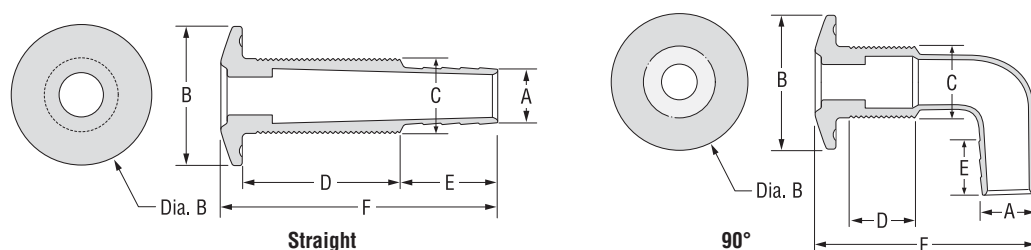

A Hose Size	B Flange Dia.	C Thread O.D.	D Thread Length	E Barb Length	F Total Length	Installation Hole Saw Size	Max Hull Thickness	Bulk Packaging	Aftermarket Packaging**
<b>THRU-HULLS, STANDARD LENGTH</b>									
5/8" I.D.	1-7/8"	1.29"	1.54"	1"	3.36"	1-3/8"	1.40"	68555-1	68555-3
3/4" I.D.	1-7/8"	1.29"	1.54"	1"	3"	1-5/16"	1.40"	68554-1	68554-3
1" I.D.	1-7/8"	1.29"	1.54"	1"	3"	1-5/16"	1.40"	68556-1	68556-3
1-1/8" I.D.	1-7/8"	1.29"	1.54"	1.32"	2-7/8"	1-5/16"	1.40"	68557-1	68557-3
1-1/4" I.D.	2-3/8"	1.55"	1.54"	1.6"	3.96"	1-1/2"	1.40"	68550-1	68550-3
1-1/2" I.D.	2-3/8"	1.55"	1.54"	1.6"	6.09"	1-5/16"	1.40"	68551-1	68551-3
2" I.D.	3-1/4"	2.16"	2.09"	1.96"	4.94"	2-1/8"	1.80"	68552-1	68552-3
<b>THRU-HULLS, LONG LENGTH</b>									
5/8" I.D.	1-7/8"	1.29"	1.60"	1.27"	3.48"	1-3/8"	1.40"	68576-1	68576-3
3/4" I.D.	1-7/8"	1.29"	1.60"	1.27"	3.48"	1-3/8"	1.40"	68577-1	68577-3
1" I.D.	1-7/8"	1.29"	1.60"	0.75"	3.48"	2.76"	1.40"	68582-1	68582-3
1-1/8" I.D.	1-7/8"	1.29"	1.60"	1.27"	3.75"	1-3/8"	1.40"	68578-1	68578-3
1-1/4" I.D.	1-7/8"	1.29"	1.60"	1.5"	3.75"	1-3/8"	1.40"	68579-1	68579-3
1-1/2" I.D.	2-3/8"	1.55"	1.54"	1.5"	3.92"	1-1/2"	1.40"	68580-1	68580-3
2" I.D.	2-3/8"	1.55"	1.54"	1.5"	3.92"	1-1/2"	1.40"	68581-1	68581-3
<b>SCUPPER VALVE</b>									
2" I.D.	3-1/4"	2.16"	2.09"	1.96"	4.94"	2-1/8"	1.80"	68590-1	68590-3



\*\* -3 = Skin Pack

STAINLESS STEEL CAPPED COMPOSITE THRU-HULLS

# Thru-Hulls

Made of thermoplastic resins.

**Caution:** Plastic Thru-Hull Connectors are designed for installation above the water line only.

Fits Hose Size	Stem Length	Max Hull Thickness	Flange Diameter	Installation Hole Saw Size	Construction	Color	Bulk Packaging	Aftermarket Packaging**
5/8" I.D.	3-1/4"	1-1/4"	1-3/4"	1-1/8"	Polypropylene	White	<b>3872-1</b>	<b>3872-3</b>
Accommodates 7534A (5/8") bailer plug						Black	<b>3872A1</b>	—
3/4" I.D.	3-1/4"	1-1/4"	1-3/4"	1-1/8"	Polypropylene	White	<b>3873-1</b>	<b>3873-3</b>
Accommodates 7534A (5/8") bailer plug						Black	<b>3873A1</b>	—
3/4" I.D.	4"	2"	2"	1-1/16" to 1-1/8"	Acetal	White	<b>3896-1</b>	<b>3896-3</b>
1-1/8" to 1-1/4" I.D.	3-1/4"	1-1/4"	2-1/4"	1-3/8"	Polypropylene	White	<b>3874-1</b>	<b>3874-3</b>
Accommodates 7535A (7/8") bailer plug						Black	<b>3874A1</b>	—
1-1/8" to 1-1/4" I.D.	4-1/8"	1-5/16"	2-1/4"	1-7/16" to 1-1/2"	Acetal	White	<b>3897-1</b>	<b>3897-3</b>
						Black	<b>3883-1</b>	—
1-1/2" I.D.	3-1/2"	1-1/4"	3"	1-7/8" to 2"	Polypropylene	White	<b>3875-1</b>	<b>3875-3</b>
Accommodates 7535A (7/8") bailer plug						Black	<b>3875A1</b>	—
Replacement nut						Polypropylene	White	<b>911078A1</b>
2" I.D.	3-1/2"	1-1/4"	3"	1-7/8" to 2"	Polypropylene	White	<b>3845-1</b>	—



## Thru-Transom Thru-Hull Connector

For installation through the transom. Ideal for overflow use in livewell installations. Can be used with the 3876 Scupper Valve in self-bailing applications, or as an exhaust port for a bilge pump. Polypropylene construction.

**Caution:** Plastic Thru-Hull Connectors are designed for installation above the water line only.

Fits Hose Size	Stem Length	Max Hull Thickness	Flange Diameter	Installation Hole Saw Size	Color	Bulk Packaging	Aftermarket Packaging
1-1/2" I.D.	5-1/2"	3-1/8"	2-3/4"	2"	White	<b>3875B1</b>	—
Replacement nut						White	<b>911078A1</b>



## Double Ended Thru-Hull Connector

Double-ended thru-hull provides watertight transition through bulkheads or tanks. 5" overall length. Polypropylene construction.

**Caution:** Plastic Thru-Hull Connectors are designed for installation above the water line only.

Fits Hose Size	Max Hull Thickness	Installation Hole Saw Size	Bulk Packaging	Aftermarket Packaging**
3/4" I.D.	1-1/8"	1-1/8"	<b>3878-1</b>	<b>3878-3</b>



## 90° Thru-Hull Connectors

90° thru-hulls are ideal for tight installations, such as livewell overflow drains. Design eliminates hose kinking. Polypropylene construction.

**Caution:** Plastic Thru-Hull Connectors are designed for installation above the water line only.

Fits Hose Size	Max Hull Thickness	Flange Diameter	Installation Hole Saw Size	Color	Bulk Packaging	Aftermarket Packaging**
3/4" I.D.	1"	1-1/2"	1"	White	<b>3877-1</b>	<b>3877-3</b>
Accommodates 7533A (1/2") bailer plug				Black	<b>3880-1</b>	—
1-1/8" to 1-1/4" I.D.	1-7/8"	2-7/16"	1-5/16"	White	<b>3879-1</b>	<b>3879-3</b>
Accommodates 7535A (7/8") bailer plug				Black	<b>3870-1</b>	—

\*\* -3 = Skin Pack



# Scupper Valve

Provides a water exit for boats with self-bailing cockpits. Acetal construction. Accommodates 3875B thru-transom thru-hull connector (screw holes must be drilled for installation.) Diameter: 2-7/8". Use as a replacement valve for 3881 Thru-Transom Scupper.

**Caution:** Plastic Thru-Hull Connectors are designed for installation above the water line only.

Description	Bulk Packaging	Aftermarket Packaging**
Valve	3876-1	3876-3
Ring only	910881A1	—



# Thru-Transom with Scupper

The rubber flapper opens to drain water out and closes to prevent backwash. Acetal construction. For 1-1/2" I.D. hose.

**Caution:** Plastic Thru-Hull Connectors are designed for installation above the water line only.

Description	Dimensions	Max Hull Thickness	Installation Hole Saw Size	Bulk Packaging	Aftermarket Packaging
Thru-transom with scupper	6-1/4" L x 2-7/8" dia.	3-1/8"	2"	3881-1	—



# Thru-Hull with Strainer

Thru-hull connector with strainer prevents clogging of the aerator pump. Strainer attaches to threads that extend beyond external retaining nut. Acetal construction.

**Caution:** Do not use strainer as a thru-hull connector nut replacement. Plastic Thru-Hull Connectors are designed for installation above the water line only.

Description	Hose Size	Max Hull Thickness	Installation Hole Saw Size	Bulk Packaging	Aftermarket Packaging**
Thru-hull with strainer	3/4" I.D.	1-7/16"	1-1/16" to 1-1/8"	3886-1	3886-3



# Mesh Strainer/ Drain Filter

Durable strainers to prevent debris from clogging baitwell drains and aerator pumps. Two types of construction: formed Stainless Steel wire mesh molded into black PVC plastic base or acetal plastic.

**Caution:** Aerator pump must be secured with aerator attachment nut prior to installing strainer.

Description	Thread	Application	Bulk Packaging	Aftermarket Packaging**
Stainless Steel mesh	7/8"-9 UNC2-B	Fits 3877-1 thru-hull	11524-1	11524-3
	3/4"-14 NPSM	Fits 3/4" aerator inlet and 3886-1 thru-hull	4232-1	4232-7
	13/8"-12 UNF	Fits 4660/4661 aerator inlet	4234-1	4234-3
Molded plastic	3/4"-14 NPSM	Fits aerator inlet and 3886-1 thru-hull	3885-1	3885-3



\*\* -3 = Skin Pack, -7 = Clamshell



# Cockpit Drains

For use with 1-1/2" I.D. hose as part of a self-bailing cockpit system. Features short stem and narrow flange for installing through cockpits. Polypropylene construction.

Description	Stem Length	Max Hull Thickness	Flange Diameter	Installation Hole Saw Size	Bulk Packaging	Aftermarket Packaging
Drain	3-3/4"	1-1/2"	2-1/8"	1-7/8"	<b>3875C1</b>	—
Drain with screen	4-3/32"	1-7/32"	2-1/8"	1-7/8"	<b>3882-1</b>	—



# Drain Fittings

These drain fittings can be used with a hose connector to create a drain. Use 3888 with 3899 or 3890 threaded/hose-to-barb connector. Use 3889 with 3891 threaded/hose-to-barb connector. Acetal construction.

Description	Dimensions	Max Hull Thickness	Installation Hole Saw Size	Bulk Packaging	Aftermarket Packaging
3/4" diameter	1-1/2"	1-1/8"	1-1/16" to 1-1/8"	<b>3888-1</b>	—
1-1/8" diameter	1-1/2"	1-1/16"	1-7/16" to 1-1/2"	<b>3889-1</b>	—



# Drain Cover

Polished stainless steel drain cover can be used for floor drains, vents, or hidden horn openings. Four holes for #6 fasteners.

Description	Bulk Packaging	Aftermarket Packaging**
Stainless Steel, 3-1/4" dia.	<b>66308-1</b>	<b>66308-3</b>



# Drain Plug and Receiver Kit

Molded black plastic with threaded receiver. Molded retaining strap. Includes attaching screws and elastomeric gasket for a watertight fit.

Description	Bulk Packaging	Aftermarket Packaging**
3/4" dia. one piece plug	<b>17209-1</b>	<b>17211-3</b>



# Garboard Drain Plugs

Provides bilge drainage when hauling out. Nut removes with wrench or pliers. Machined, tapered pipe threads ensure watertight plug fit. 3/8" neck depth. Three countersunk holes for #8 fasteners.

Description	Construction	Bulk Packaging	Aftermarket Packaging**
1/2" NPT drain	Cast bronze	<b>7555-1</b>	<b>7555-3</b>
Replacement plugs, Pair		<b>9842-1</b>	<b>9842-3</b>
Replacement plugs, 24 Pair		—	<b>9842PD1</b>
Replacement plugs, 24 Pair (Saltwater Use)		—	<b>9844PD1</b>



# Stainless Steel Garboard Drain Plugs

Threaded removable plug. Retention system keeps plug from getting lost. Large 7/8" (27mm) hole for servicing stern drives. High polished #316 stainless steel reduces corrosion.

Description	Construction	Bulk Packaging	Aftermarket Packaging**
7/8" diameter	Stainless Steel	<b>7557-1</b>	<b>7557-7</b>
7/8" diameter	Stainless Steel with Gasket	<b>7557G1</b>	—
Gasket		—	<b>7557-03</b>
O-Ring		—	<b>7557-04</b>



\*\* -3 = Skin Pack, -7 = Clamshell, PD1 = PDQ Display

DRAINS AND DRAIN PLUGS

## T-Handle Drain Plugs

For 1" diameter drains. A clockwise turn of the T-handle locks the plug in place; turn counterclockwise to release. Available in brass or stainless steel, with or without chain.

Description	Bulk Packaging	Aftermarket Packaging**
<b>BRASS HANDLE</b>		
Without chain	7526A1	7526A7
100 units (w/o chain) in battery box display. One UPC sheet for use with all 100 units	—	7526D1
24 units (w/o chain) in PDQ display carton	7526PD1	7526PD1
<b>BRASS PLATED HANDLE</b>		
Without chain	—	11592-3
24 units (w/o chain) in PDQ display carton	11587-4	11587-4
<b>STAINLESS STEEL HANDLE</b>		
Without chain	7518A1	7518A3
24 units (w/o chain) in PDQ display carton	—	7518DP1



## Snap-Handle Drain Plugs

Snap-handle drain plugs for 1" diameter drains. A clockwise turn of the handle tightens the plug in its tube, and the handle flips down to lock. Available in brass or stainless steel, with or without chain.

Description	Bulk Packaging	Aftermarket Packaging**
<b>BRASS HANDLE</b>		
Without chain	7524A1	7524A7
With 5" chain	7524B1	—
75 units (w/o chain) in battery box display, one UPC sheet for use with all 75 units	—	7524D1
24 units (w/o chain) in PDQ display carton	7524PD1	7524PD1
<b>BRASS PLATED HANDLE</b>		
Without chain	—	11591-3
24 units (w/o chain) in PDQ display carton	11586-4	11586-4
<b>STAINLESS STEEL HANDLE</b>		
Without chain	7520A1	7520A3
24 units (w/o chain) in PDQ display carton	—	7520PD1

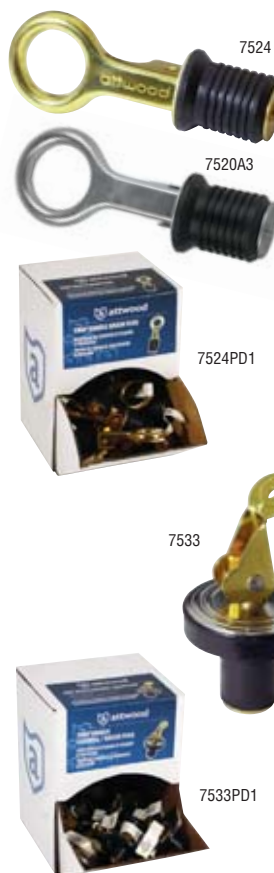

## Livewell/Bailer Drain Plugs, Snap-Handle

Cam-action neoprene plugs snap shut to form stopper for livewells / baitwells. Clockwise turn of the handle tightens plug, lever flips down to lock. Ideal for livewell drains. Brass snaps and plates. **Note:** Not for use with chemicals or fuels.

Description	Bulk Packaging	Aftermarket Packaging**
For 3/8" I.D. thru-hull	7531A1	7531A3
For 7/16" I.D. thru-hull	7532A1	7532A3
For 1/2" I.D. thru-hull	7533A1	7533A7
24 units for 1/2" thru-hull in PDQ display carton	—	7533PD1
For 5/8" I.D. thru-hull	7534A1	7534A3
For 7/8" I.D. thru-hull	7535A1	7535A3



## Drain Tubes

Drain tubes for 1"-diameter drain plugs. Use aluminum drain tubes with aluminum-handle drain plugs; use brass tubes with brass-handle plugs and stainless steel plug handles. Tubes have .032" wall thickness.

Description	Length	Bulk Packaging	Aftermarket Packaging
Brass Drain Tube	1-7/8"	7566AR1	—
	2-3/8"	7566BG1	—
	2-7/8"	7566BR1	—
	3"	11446-1	—



\*\* -3 = Skin Pack, -4 = Individual Carton, A7 = Clamshell, PD1 = PDQ Display

### DRAIN PLUGS AND DRAIN TUBES

# TURBO IN-LINE BLOWERS

The first vane axial-flow fan bilge blowers designed using aerospace technology to maximize performance. No other bilge blowers in the industry provide such powerful system output at such low power input in a compact size.

- Patented in-line design – provides ventilation for engine compartments, galleys, bilges, and heads.
- System airflow exceeds old-style in-line blowers by as much as 25%
- Draws up to 40% fewer amps, making our Turbo blowers up to four times more efficient than competitive blowers.

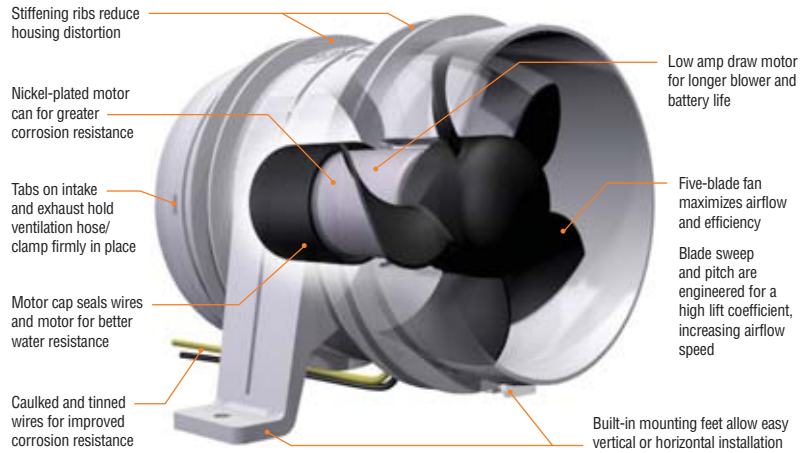

## NMMA Numbers

Part No.	NMMA No.	IMCI (CE) Certificate No.
1731 Series	90928	FATT001
1733 Series	90928	FATT005
1747 Series	—	EFATT001
1749 Series	—	EFATT001
1751 Series	—	EFATT002

## Pump Dimensions

Model No.	A	B	C	D
<b>Turbo 3000</b>	3-5/8"	4-1/2"	5-1/16"	3"
<b>Turbo 4000</b>	4-17/32"	5-1/2"	6-1/16"	4"

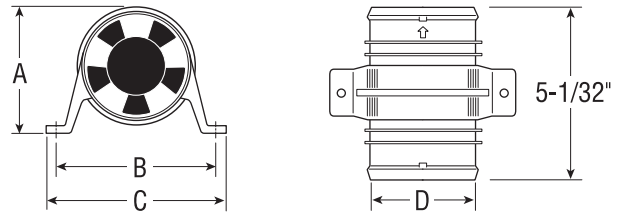

## Specifications

Model No.	Rated Voltage	CFM Open Flow	CFM In System*	Current Draw Amps	Fuse Size
Turbo 3000	12V nominal	120	90	2.6	4-amp
	13.6V design	145	100	3.1	4-amp
Turbo 4000	12V nominal	200	100	2.5	5-amp
	13.6V design	230	125	2.9	5-amp
	24V nominal	200	100	1.5	3-amp
	27.2V design	230	125	2.0	3-amp

## Turbo 3000 Series

For 3" I.D. ventilation hose. Install with #10 fasteners. Individual carton includes 2 tie straps.

Model No.	Description	Bulk Packaging	Aftermarket Packaging**
Turbo 3000	Standard, 12-volt, White, 1-year Warranty	<b>1731-1</b>	<b>1731-4</b>
	Water-resistant, 12-volt, White, 3-year Warranty	<b>1733-1</b>	<b>1733-4</b>



## Turbo 4000 Series II

Our new blower system matches air flow of existing in-line blowers at a significantly reduced noise level. For added durability, Attwood incorporates an engineered plastic housing that resists deformation during installation and prevents blade to housing interference. For 4" I.D. ventilation hose. Install with #10 fasteners. Individual carton includes 2 tie straps.

Model No.	Description	Bulk Packaging	Aftermarket Packaging**
Turbo 4000	Standard, 12-volt, White, 1-year Warranty	<b>1747-1</b>	<b>1747-4</b>
	Water-resistant, 12-volt, White, 3-year Warranty	<b>1749-1</b>	<b>1749-4</b>
	Water-resistant, 24-volt, White, 3-year Warranty	<b>1751-1</b>	—



\* In system = 3 ft. of duct with one 90° bend, a collector box and louvered vent on discharge side of blower at 13.6 VDC  
 \*\* -4 = Individual Carton

# VENTS & COLLECTOR BOXES

Attwood hull-mounted vents are designed to install by fastening as a complete unit from either inside or outside the hull. Ventilation hose (not included) twists into the bottom of the box to form a raised water barrier. Plastic vents are corrosion-resistant and will not discolor. All collector boxes and vents are designed for intake or exhaust and meet ABYC H-2 cross sectional area requirements.

## Stainless Steel Louvered Vent

All-welded #304 Stainless Steel construction with polished finish. Install with #8 fasteners. Requires collector box 1487A for 3" system, or 1487B for 4" system.

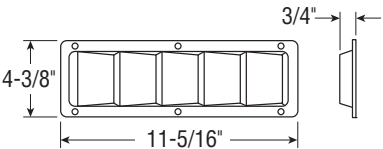

For use with Collector Box(es)	Dimensions	Bulk Packaging	Aftermarket Packaging**
1487A, 1487B	3-1/4" x 10-3/8"	1488-1	1488-5



## Collector Boxes

Collector boxes for use with 1488 stainless steel vent. Available with cut-out for two 3" I.D. wire-supported hoses or one 4" I.D. wire-supported hose. Corrosion-resistant plastic.

Description	Depth	Installation Hole Saw Size	For Use with Vent(s)	Bulk Packaging	Aftermarket Packaging
For two 3" I.D. hoses	5-9/16"	3-5/8" x 10-3/4"	1488	1487A1	—
For one 4" I.D. hose	5-9/16"	4-5/8" x 10-3/4"	1488	1487B1	—



## Narrow Stainless Steel Louvered Vents

Suitable for installation on any flat or most contoured hulls. Constructed of all-welded #304 Stainless Steel with a polished finish. Vents for use with 3" I.D. ventilation systems, and require a 1343 collector box. Install with #6 fasteners.

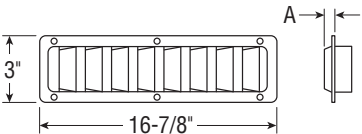

For use with Collector Box	A Depth	Open Hole Size	Bulk Packaging	Aftermarket Packaging**
1343	9/16"	2-1/16" x 15-15/16"	1493-1	1493-5
1343	1/16"	2-1/16" x 15-15/16"	1499-1	1499-5



## Collector Box

For use with narrow Stainless Steel vents (1493 or 1499), with two 3" I.D. wire-supported ventilation hoses. Corrosion-resistant plastic.

Description	Depth	Installation Hole Saw Size	For Use with Vent(s)	Bulk Packaging	Aftermarket Packaging
For two 3" I.D. hoses	4-1/16"	2-7/16" x 16-3/16"	1493, 1499	1343-1	—



\*\* -5 = Poly Bag



## Venturi Vents

Clean, contemporary, louver design. Corrosion-resistant, paintable ABS plastic. For 3" or 4" I.D. ventilation system. Requires 1341 collector box for 3" system, or 1342 for 4" system. Install with #8 fasteners. Sized for installation even on highly-contoured decks.



For use with Collector Box	Description	Open Hole Size	Bulk Packaging	Aftermarket Packaging**
1341, 1342	Chrome	2" x 15-3/8"	<b>1494-1</b>	<b>1494-5</b>
	Black	2" x 15-3/8"	<b>1494A1</b>	<b>1494A5</b>
	White	2" x 15-3/8"	<b>1494F1</b>	—



## Flush Louvered Vents

Canted louvers deflect rain and spray and help conceal the collector box. Installs flush to hull. Drain slots to prevent water accumulation. Black vent is ABS plastic, white vent is ASA plastic. Both are paintable. Install with #8 fasteners. Requires 1341 collector box for 3" system, or 1342 for 4" system.

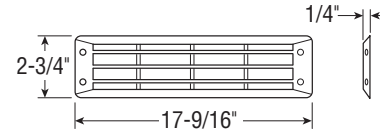

For use with Collector Box	Description	Open Hole Size	Bulk Packaging	Aftermarket Packaging**
1341, 1342	Chrome	2" x 15-1/4"	<b>1426-1</b>	<b>1426-5</b>
	Black	2" x 15-1/4"	<b>1423-1</b>	<b>1423-5</b>
	White	2" x 15-1/4"	<b>1425-1</b>	<b>1425-5</b>
	Off-White	2" x 15-1/4"	<b>1424-1</b>	<b>1424-5</b>



## Collector Boxes

For use with Venturi, Flush Louvered or Trimline Vents. Corrosion-resistant plastic.

Description	Depth	Installation Hole Saw Size	For Use with Vent(s)	Bulk Packaging	Aftermarket Packaging
For two 3" I.D. hoses	3-7/8"	2-1/16" x 15-9/16"	1494, 1423, 1424, 1425, 1426, 1496A	<b>1341-1</b>	—
For one 4" I.D. hose	5"	2-1/8" x 15-5/8"	1494, 1423, 1424, 1496A	<b>1342-1</b>	—



## Plastic Louvered Vents

Constructed of paintable, corrosion-resistant ABS plastic with no sharp edges. For 3" I.D. ventilation system with 1345 collector box. Install with #8 fasteners.

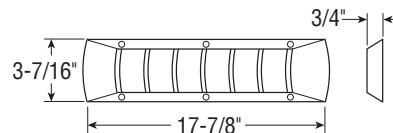

For use with Collector Box	Description	Open Hole Size	Bulk Packaging	Aftermarket Packaging**
1345	Chrome Plated	2-1/4" x 16"	<b>1495B1</b>	<b>1495B5</b>
	Black	2-1/4" x 16"	<b>1495A1</b>	—
	Off-White	2-1/4" x 16"	<b>1495-1</b>	—



## Collector Box

For use with plastic louvered vent, with two 3" I.D. wire-supported ventilation hoses. Box fastens to vent with screws or pop rivets, then vent fastens to the deck. Corrosion-resistant plastic.

Description	Depth	Installation Hole Saw Size	For Use with Vent(s)	Bulk Packaging	Aftermarket Packaging
For two 3" I.D. hoses	4"	2-7/16" x 16-1/4"	1495	<b>1345-1</b>	—



\*\* -5 = Poly Bag

## Modular Vents

Modular construction to accommodate any ventilation opening size by interlocking two or more center sections. End sections interlock to the center section for a finished appearance. For 4" I.D. ventilation systems using one or more 1348 collector boxes. End sections have two holes for #8 fasteners.

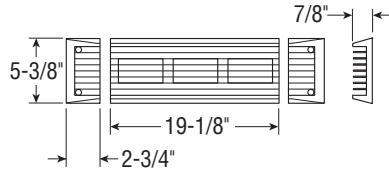

Description	Color	Open Hole Size	Bulk Packaging	Aftermarket Packaging
Center Sections	Chrome	2-1/2" x 17-3/4"	<b>1438-1</b>	—
	White	2-1/2" x 17-3/4"	<b>1438F1</b>	—
End Sections	Chrome	2-1/2" x 17-3/4"	<b>1439-1</b>	—
	White	2-1/2" x 17-3/4"	<b>1439F1</b>	—



## Collector Box

For use with modular vents, with 4" I.D. wire-supported ventilation hose. Corrosion-resistant plastic.

Description	Depth	Installation Hole Saw Size	For Use with Vent(s)	Bulk Packaging	Aftermarket Packaging
For two 4" I.D. hoses	5"	2-3/4" x 18"	1438, 1439	<b>1348-1</b>	—



## Cowl Ventilator

For use with 3" I.D. wire-supported ventilation hose. Flexible hose flange is screwed onto hose, then vent snaps onto the flange. Vent constructed of chrome-plated die-cast Perma-Plate® ZAMAK. Flange is non-corrosive plastic. Installs with #8 fasteners.

Description	Installation Hole Size	Bulk Packaging	Aftermarket Packaging**
5-5/16" W x 6" L x 2-1/4" H (neck extends 1" below deck)	3-1/4" x 3-1/2"	<b>1364A1</b>	<b>1364A3</b>



## Twist-On Hose Flange

For use with 3" I.D. wire-supported ventilation hose. Hose installs from topside by turning the flange into the hose spiral, passing the hose through the deck hole, then mounting ventilator. No hose clamps needed. Corrosion-resistant plastic. Four holes for required #10 fasteners.

Description	Installation Hole Size	Bulk Packaging	Aftermarket Packaging**
Twist-On Hose Flange, Black	5"	<b>1405-1</b>	<b>1405-3</b>



## Storage Vent

Use to vent lockers and storage areas. Provides over six square inches of ventilation opening. Will not accept a ventilation hose. Corrosion-resistant plastic. Two holes for required #6 fasteners.

Description	Height	Neck	Flange Dia.	Installation Hole Size	Bulk Packaging	Aftermarket Packaging
Black	1-1/16"	5/8"	3-3/16"	3-1/16" to 3-1/8"	<b>1353-1</b>	—
White	1-1/16"	5/8"	3-3/16"	3-1/16" to 3-1/8"	<b>1352-1</b>	—



## Clamshell Vent

Provides a seal and splash protection for vent holes, wire and hose openings. Sizes to fit most common applications. Durable 300 series stainless steel construction. Three holes for required #6 fasteners.

### Specifications

Vent Width	Size	Max Hole Size	Hose/Wire Max Size	Fasteners Size
1-3/16"	1-9/16" L x 1/2" H	1"	7/16"	#6
2-3/16"	2-1/4" L x 9/16" H	1-1/2"	9/16"	#6

Description	Dimensions	Bulk Packaging	Aftermarket Packaging**
Stainless Steel	1-3/16"	<b>66399-1</b>	<b>66399-3</b>
	2-3/16"	<b>66400-1</b>	<b>66400-3</b>

\*\* -3= Skin Pack

